

0.8 Amp, 2 Amp and 4 Amp SCRs in a SOT-223



CZS5064 and CS223 Series

features

- 400 Volts (CZS5064)
- 600 and 800 Volts (CS223-2 Series CS223-4 Series)
- Low 1.8mm profile (23% lower than DPAK)
- Utilizes 28% less board space than an industry standard DPAK

description

The CENTRAL SEMICONDUCTOR CZS5064 (0.8 Amp), CS223-2M series (2 Amp), and CS223-4M series (4 Amp) types are Epoxy Molded Silicon Controlled Rectifiers designed for sensing circuit applications and control systems. The small size and low profile of these SOT-223 devices are perfect for designs with a limited board space or height requirements.

For information on these devices or any other thyristors manufactured by Central™, visit: www.centrasemi.com/thyristors

Sample Devices available upon request.



selection guide

With Central you're not limited to just 0.8 amp in a SOT-223.

		Extended Range	
I_T (AMPS)	0.8	2.0	4.0
@ T_C (°C)	25	60	85
I_{TSM} (AMPS)	10	10	30
V_{DRM}, V_{RRM} (VOLTS)			
400	CZS5064		
600		CS223-2M	CS223-4M
800		CS223-2N*	CS223-4N*
I_{GT}	200 μ A	200 μ A	200 μ A
V_{GT}	0.8V	0.8V	0.8V
I_H	5.0mA	2.0mA	2.0mA

* 800 volt devices are available on request. Please consult factory.

2005 Discrete Thyristor Databook

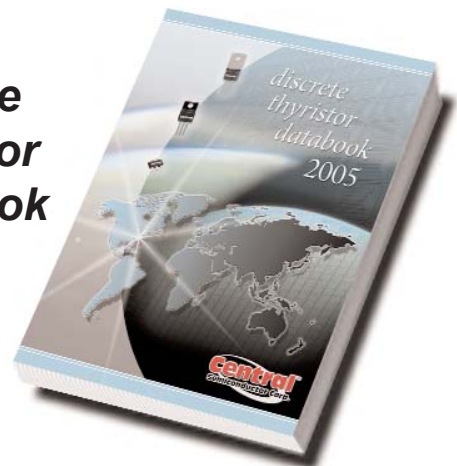

To order please visit: www.centrasemi.com/catalog

0.8 Amp, 2 Amp and 4 Amp SCRs in a SOT-223

Mechanical Specifications - SOT-223

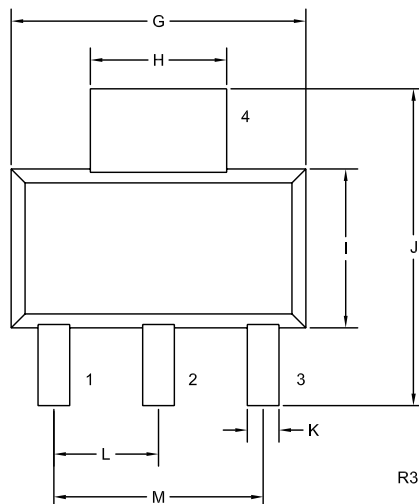
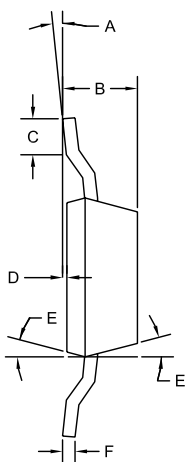

SYMBOL	INCHES		MILLIMETERS	
	MIN	MAX	MIN	MAX
A	0°	10°	0°	10°
B	0.059	0.071	1.50	1.80
C	0.018	---	0.45	---
D	0.000	0.004	0.00	0.10
E	15°		15°	
F	0.009	0.014	0.23	0.35
G	0.248	0.264	6.30	6.70
H	0.114	0.122	2.90	3.10
I	0.130	0.146	3.30	3.70
J	0.264	0.287	6.70	7.30
K	0.024	0.033	0.60	0.85
L	0.091		2.30	
M	0.181		4.60	

SOT-223 (REV: R3)

Mounting Pad Geometry (Dimensions in mm)

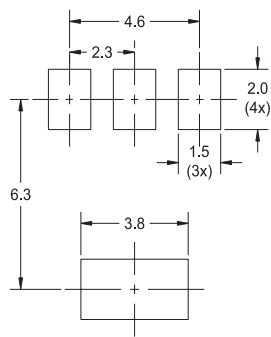

R1

Tape Dimensions and Orientation (Dimensions in mm)

Tape Width:
12mm

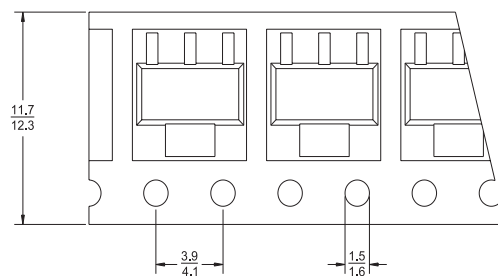

Direction of Unreeling

* Devices are taped in accordance with Electronic Industries Association Standard EIA-481-1-A

R1

Packaging Base

- 7" Reel = 1,000 pcs. (add TR suffix to part number)
- 13" Reel = 4,000 pcs. (add TR13 suffix to part number)
- Bulk = 250 pcs. (add BK suffix to part number)

Lead Code:

- 1) CATHODE 2) ANODE
- 3) GATE 4) ANODE

Ordering Information

- For devices taped and reeled on 7" reels, add TR suffix to part number.
- For devices taped and reeled on 13" reels, add TR13 suffix to part number.
- For devices bulk packed, add BK suffix to part number.
- All SMDs are available bulk packed, for prototype and manual placement applications.

For more information on this product please visit our website at www.centrasemi.com

CentralTM
Semiconductor Corp.

Innovations in Discrete
Semiconductors

For further information contact:
Sales at Central Semiconductor Corp.
(631) 435-1110 or visit our website at:
www.centrasemi.com

145 Adams Avenue • Hauppauge • New York • 11788 • USA • Tel:(631) 435-1110 • Fax: (631) 435-1824

PA SOT-223 SCR